

Cassette Sprocket (10-Speed)

CS-HG62-10

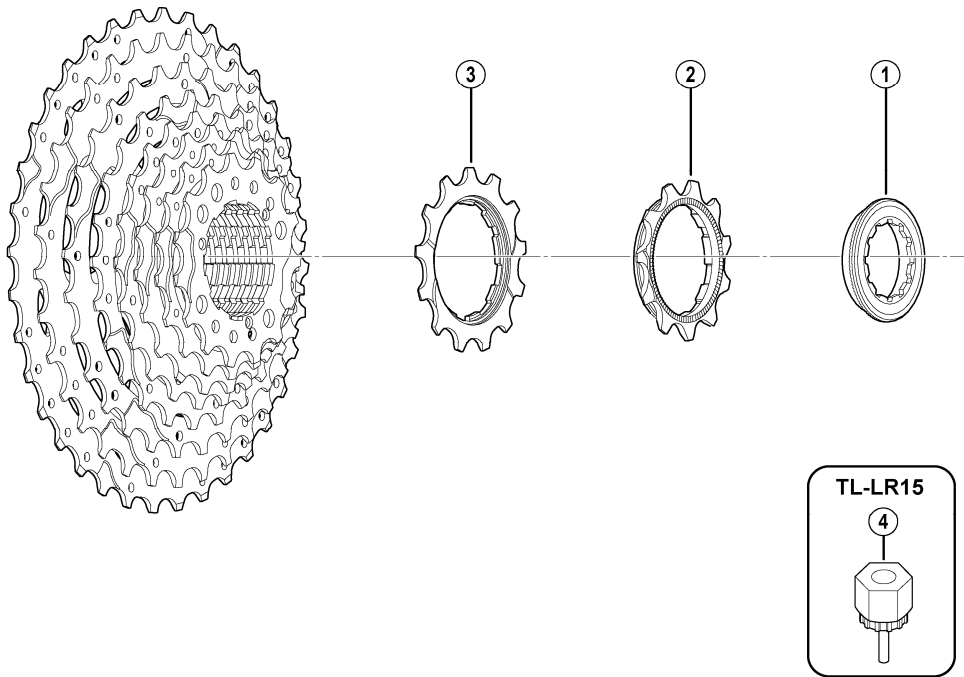

- bL-group sprocket teeth combination: 11-12-14-16-18-20-22-25-28-32T
- bJ-group sprocket teeth combination: 11-13-15-17-19-21-23-26-30-34T
- bk-group sprocket teeth combination: 11-13-15-17-19-21-24-28-32-36T

CS-HG81-10

ITEM NO.	SHIMANO CODE NO.	DESCRIPTION	INTERCHANGEABILITY	
* 1	Y1YE98040	Lock Ring		
* 2	Y1YS11100	Sprocket Wheel 11T (Built in spacer type) for bL-Group	A	
	Y1YS11000	Sprocket Wheel 11T (Built in spacer type) for bJ/bk-Group	A	
* 3	Y1YS12000	Sprocket Wheel 12T (Built in spacer type) for bL-Group	A	
	Y1YS13000	Sprocket Wheel 13T (Built in spacer type) for bJ/bk-Group	A	
4	Y12009230	Lock Ring Removal Tool (TL-LR15)	A	

A: Same parts.

B: Parts are usable, but differ in materials, appearance, finish, size, etc.
Absence of mark indicates non-interchangeability.

Mar.-2013-3197B
© Shimano Inc. A

Specifications are subject to change without notice.

SHIMANO